



Seaside K12 Campus – Board Update Seaside School District April 18, 2017

THE DESIGN PROCESS

Ed Specs / Visioning

Master Planning

Schematic Design

Design Development

Construction Documents

Construction

Design Process To Date:

- ***Enthusiasm*** – *High Degree of Community and Staff Engagement*
- ***Refinement of Area Program*** – *Careful Planning for a Unique Project*
- ***Due Diligence*** – *Environmental Conditions Will Inform Design Outcome*



TIMELINE

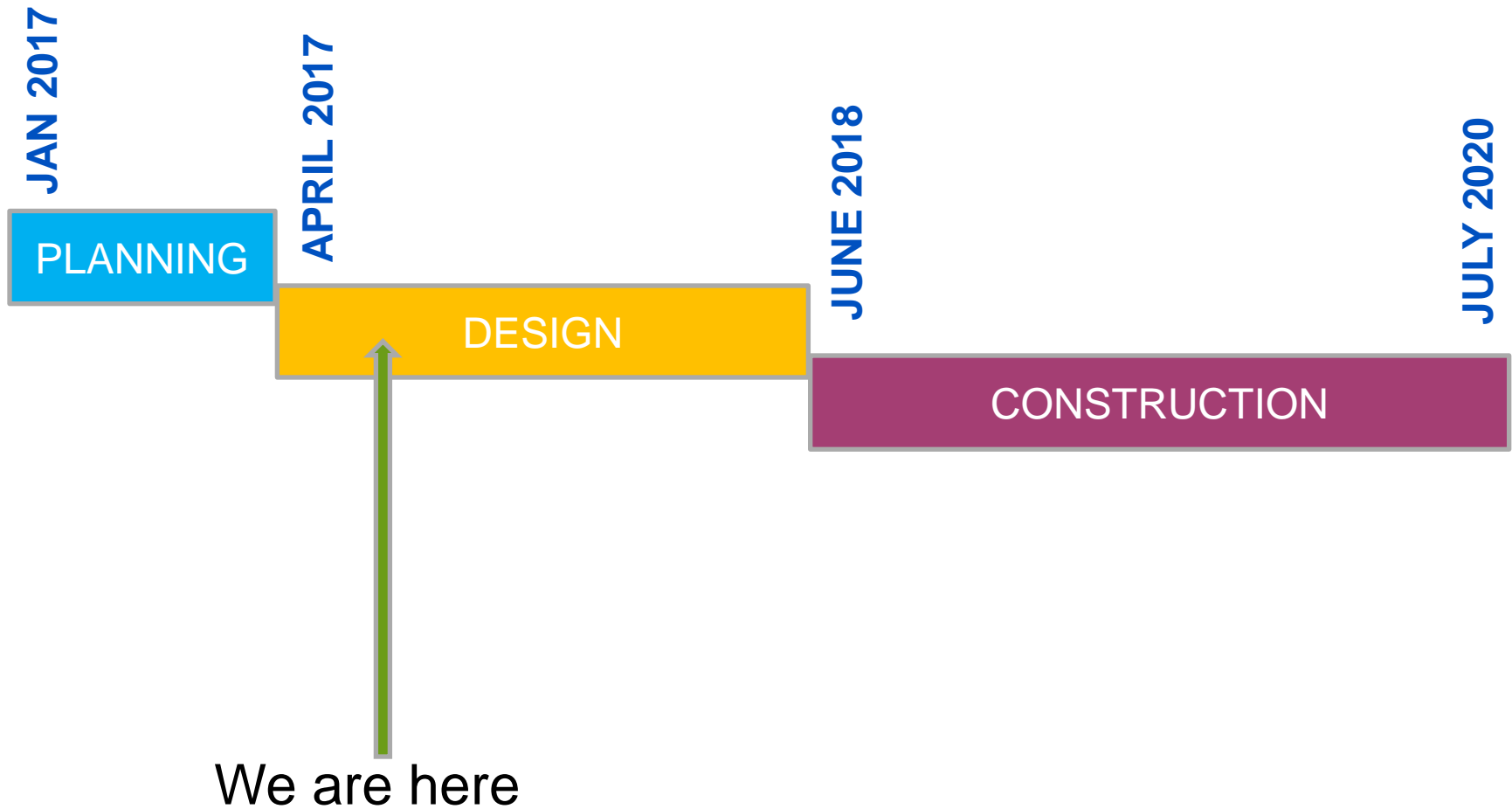

WORK TO DATE

- Focus Groups with Staff – January 31, February 9
- Draft Ed Spec to District – February 27
- School Tours – March 10
- Design Summit – March 20
- Student Involvement - April

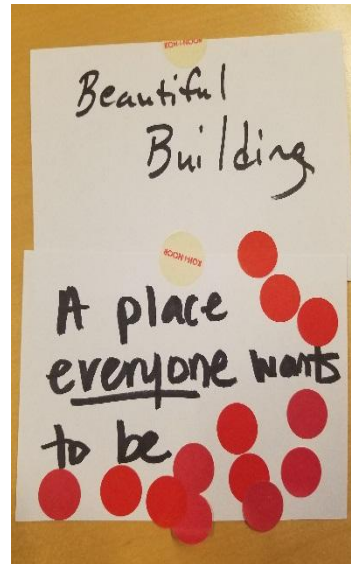

Student Design Exercise – Highlights

- Separation of Middle School and High School
- Provide Outdoor Spaces for Social and Educational Needs
- Careful Thought to Zoning of Spaces Throughout the Building
- Strong Sense of Pride in Schools and Community
- ***GREAT KIDS!!!!***



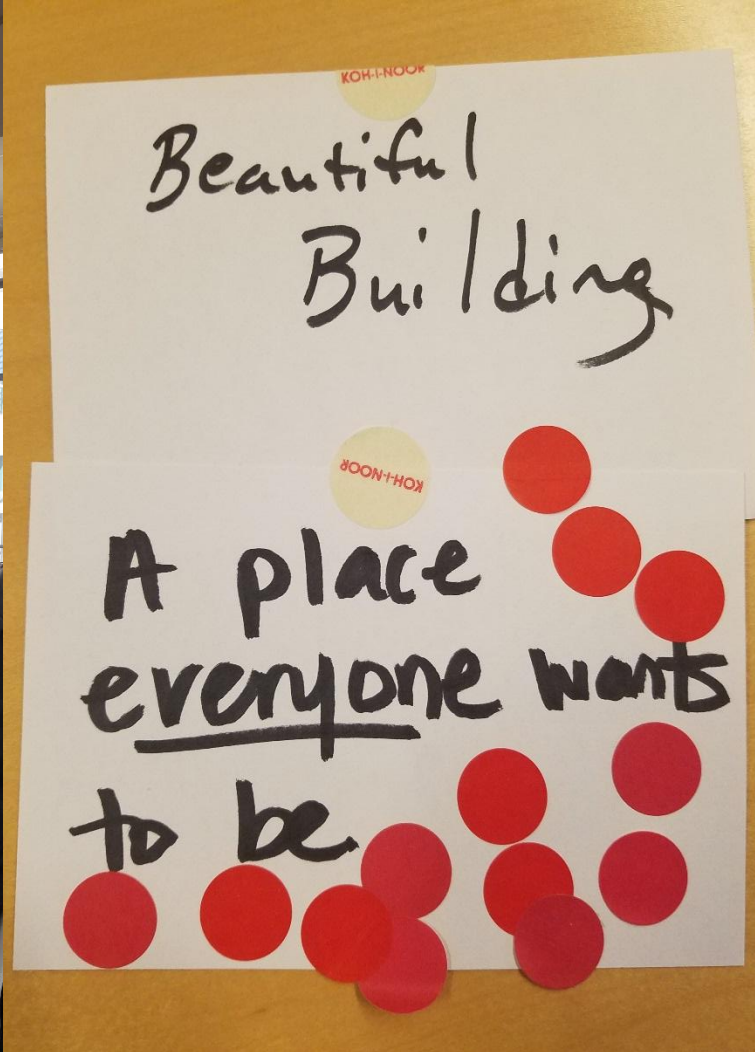
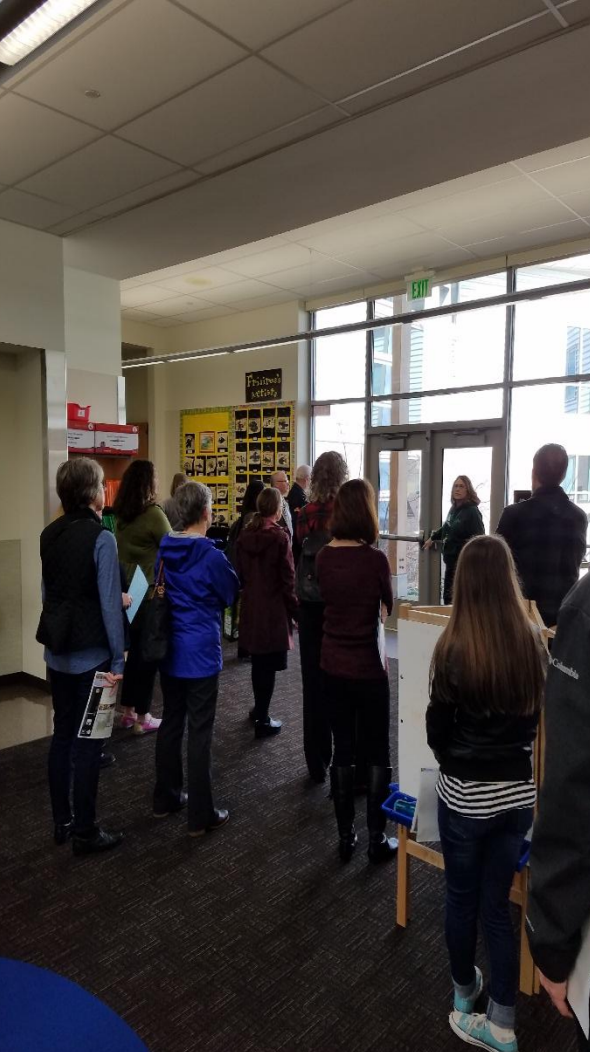

Guiding Principles

Guiding Principles (draft)

- Design student centered and community focused facilities.
- Provide facilities that reflect the community, culture and natural environment.
- Facilities (new and old) should be timeless, cohesive, flexible and inspirational.
- Construct facilities that create spaces for instruction, performance, athletics, and community.
- Incorporate natural light to enhance the learning environment.
- Design facilities and spaces that are inclusive and age appropriate at all grade levels.
- Be good stewards of the community and their investments.



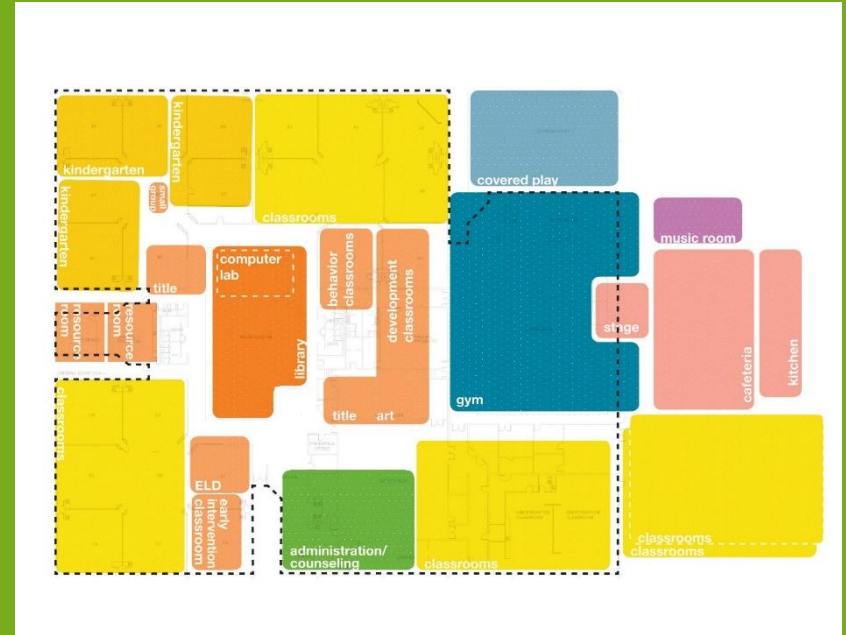

Design Team Work To Date

Table 1, Option B – Summit Diagram (28 Votes)



Table 1, Option B – *Concept Diagram*

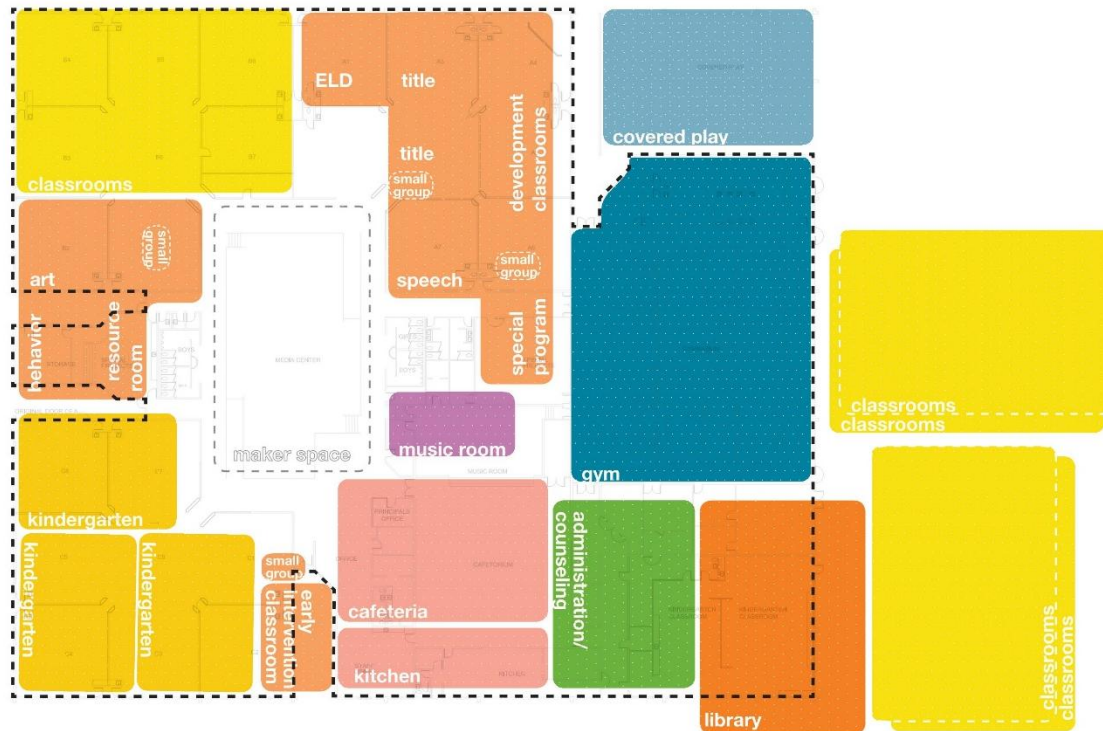

Journal

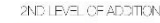

Seaside School District – Board Update
April 18, 2017

SEASIDE SC BOUL DISTRICT — seaside heights renovation and addition
April 18, 2017

Table 2, Option A – Summit Diagram (40 Votes)

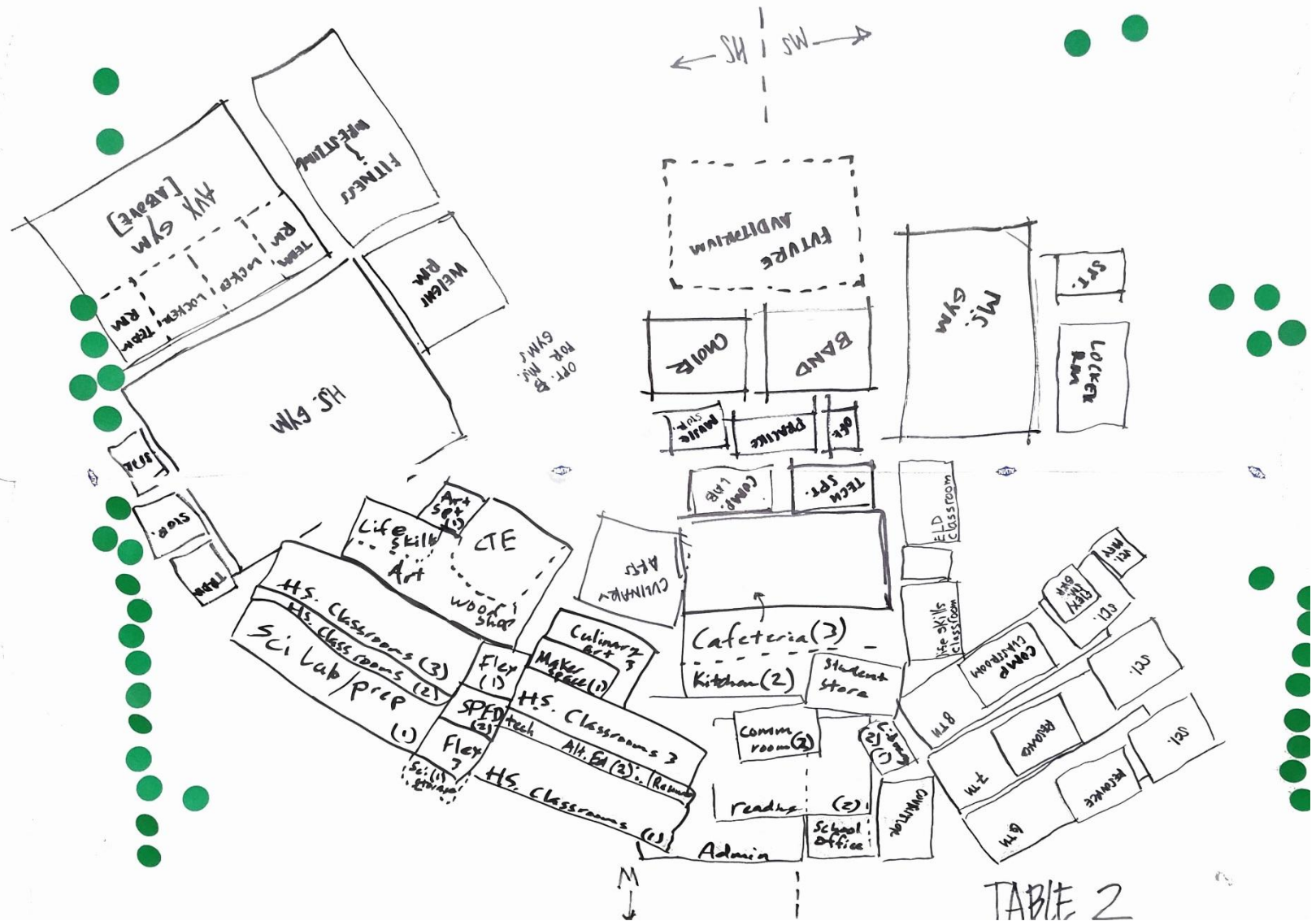
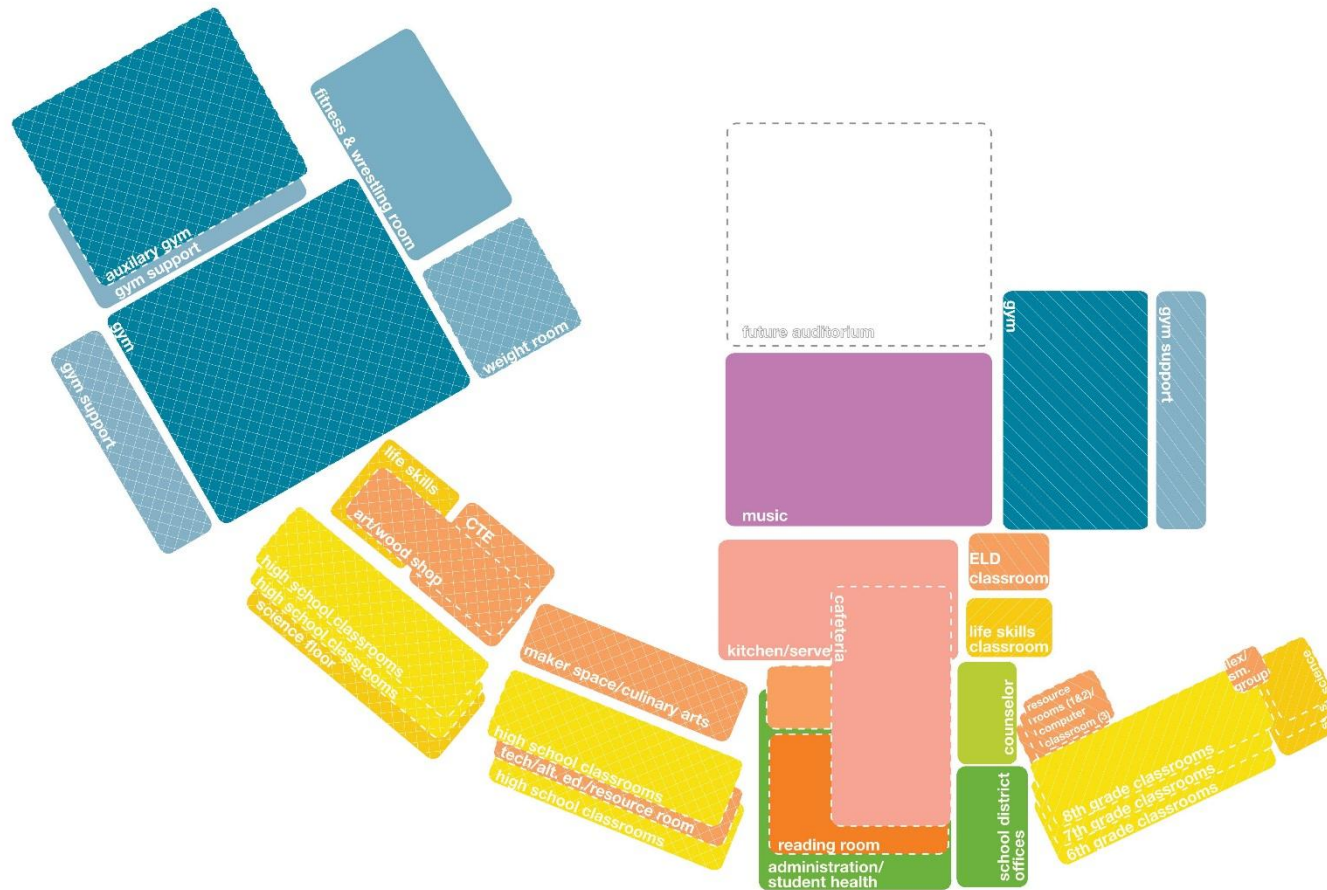
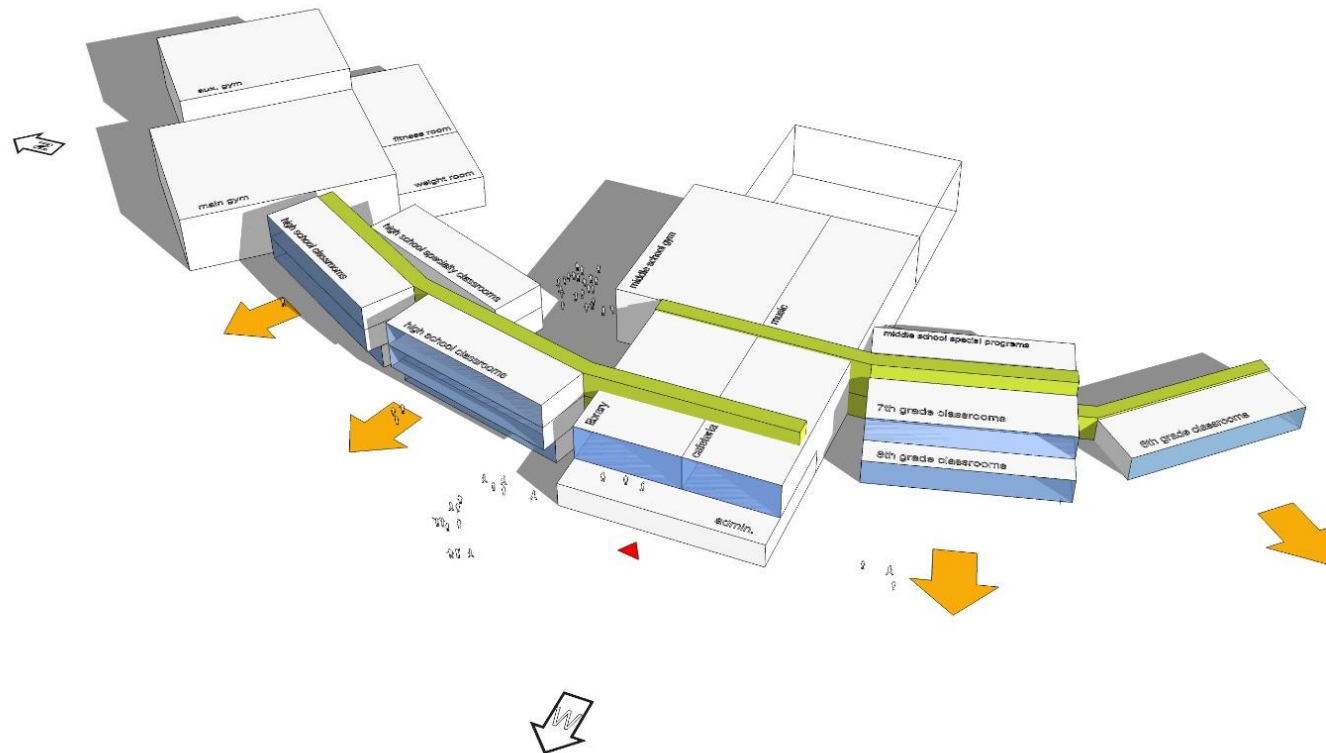

Table 2, Option A – Concept Diagram

0' 0" 0' 0" 0' 0"



MS /HS Development - Option 1B



Next Steps

- **Further Development of Preferred Design Concepts**
- **Development of Site Design – Parking, Playfields, Roadways, Landscape Concepts, Infrastructure**
- **Investigation of Key Design Topics**
 - *Resiliency and Sustainability*
 - *Technology*
 - *Building Systems*
 - *Building Materials / Coastal Climate Considerations*
- **Test Design Work Against Budget**
- **Next Meeting: May 2, 2:30 – 4:30**

